

GROUND FLOOR PLAN 1:100

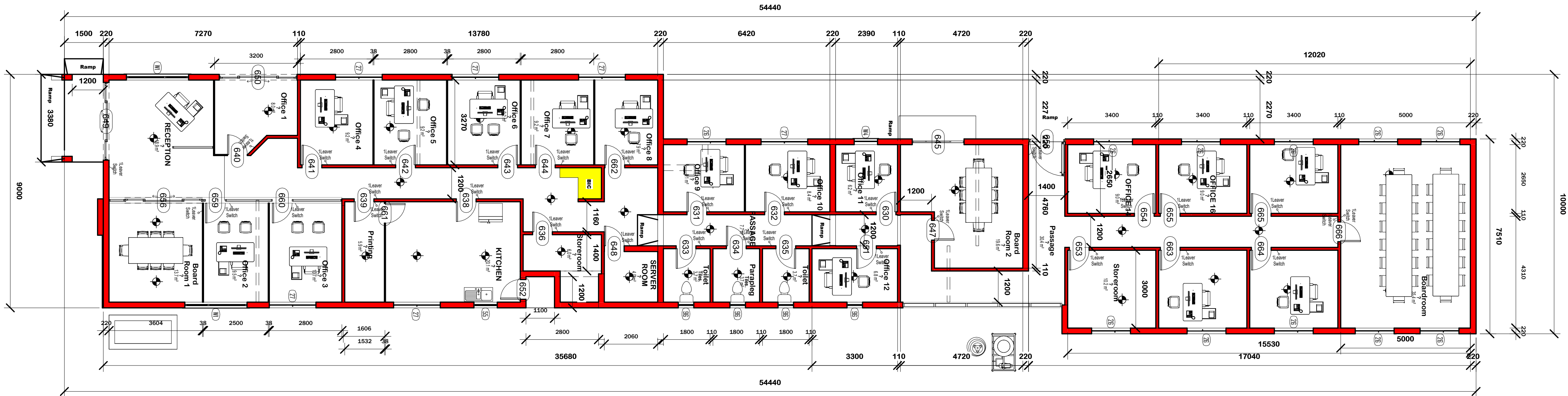

Specification

Substructure
Digging of foundation trenches is 830mm deep, hard rock and blasting included if applicable
-20MPa/15mm stone unreinforced concrete in footings
-480x230mm external Concrete Footings
-400x230mm internal Concrete Footings
-Outside walls, stock brick, 2 lines above FGL
-Brickwork to be installed every 3 courses
-350um DPC placed on last course of substructure
-25mm Screed on 150mm Mesh Wire reinforced concrete surface bed on 250um DPM on 50mm river sand blinding on 150mm hardcore
-Ant poisoning insecticides under all surface bed

Superstructure
-Brickwork placed on every 5 courses
-105x75mm precast concrete lintel / brick on edge above door and window frames

Roof
-Roof tiles/BR roof sheeting at 19degrees roof pitch on 38x38mm SAP purlins/battens at 400mm c/c maximum on 114x38mm SAP rafters at 700mm c/c maximum with 152x38mm SAP tie beam at 700mm c/c Maximum on 114x38mm SAP wall plate
-All Web members to be 114x38mm SAP grade 6
-4mm galvanised wires roof tie, 400mm girth built into brickwall

Structural
-All reinforced concrete and structural steel pillars, columns and beams to be strictly in accordance with structural engineers specification and details NS where it is applicable

Staircases
-Rise at 150mm
-Tread at 300mm
-Hand rail to be provided at a convenient height of 850mm to 900mm
-Stairs to be built with reinforced concrete

Drainage
-All Soil Pipes under building or footings to be encased in concrete of Min 100mm thickness allround
-Inspection eye at all bends and junctions of drains, with marked covers at ground level
-All waste pipes to be accessible over entire length
-No drainage bends or junction in or under floors
-Provide IE's at each end of incased drain where same passes underneath the building as nearest possible to the foundation
-Resealing traps to all waste water fittings
-Waste pipes under floors to be sleeved
-Min fall of 100mm drains to be 1:60, 300mm Min cover

Project Description

NEMURANGO CONSULTING ENGINEERING

ERF No : 10A HANS VAN RENSBURG Street
Polokwane

SITE PLAN 1:200

